

# COTTAGE

## CEDAR CREEK

2025 **WIDEBODY DESTINATION** FLOORPLANS



40FWC

40CBK

40CFD



**FOREST RIVER**

[FORESTRIVERINC.COM](http://FORESTRIVERINC.COM)

# 40CBK

**HITCH WEIGHT**  
1,565 lb.

**GVWR**  
15,565 lb.

**UVW**  
13,478 lb.

**CCC**  
2,087 lb.

**LENGTH**  
41' 6"

**HEIGHT**  
13' 5"

**WIDTH**  
101"

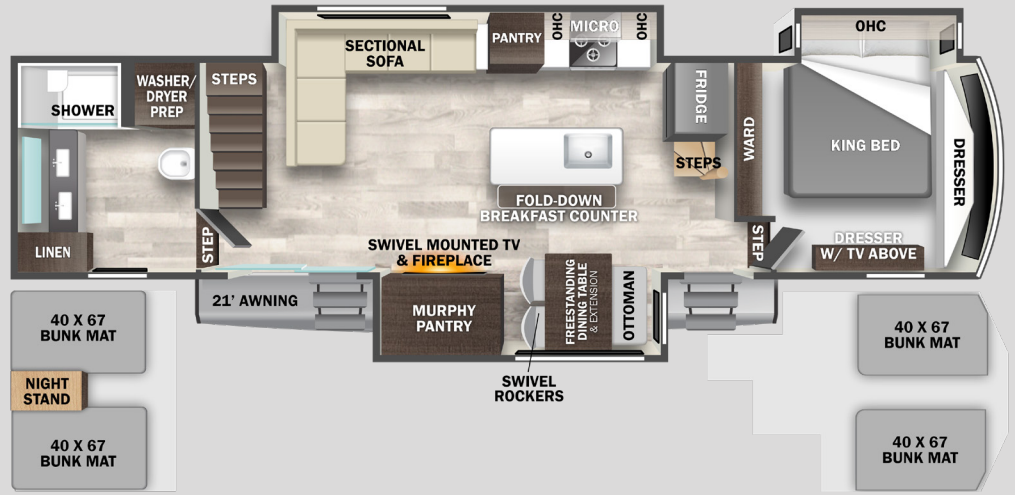

# 40CCK

**HITCH WEIGHT**  
2,100 lb.

**GVWR**  
14,000 lb.

**UVW**  
12,055 lb.

**CCC**  
1,945 lb.

**LENGTH**  
40' 6"

**HEIGHT**  
13' 5"

**WIDTH**  
101"

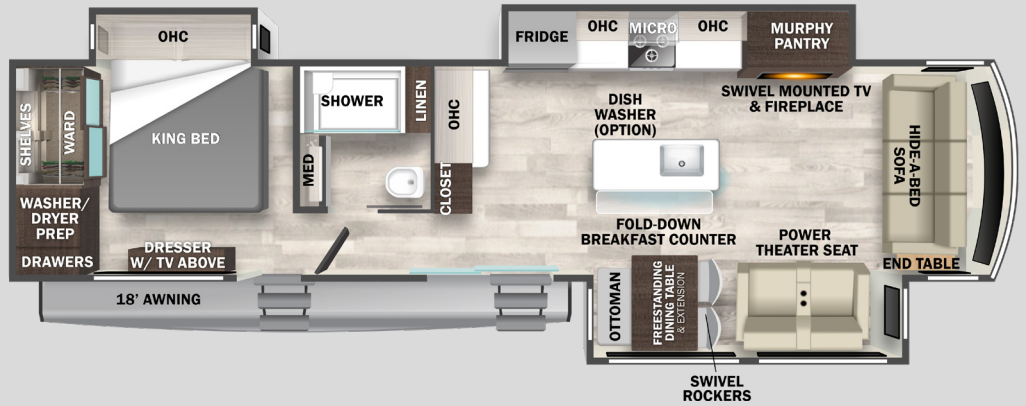

# 40CFD

**HITCH WEIGHT**  
1,238 lb.

**GVWR**  
13,238 lb.

**UVW**  
11,977 lb.

**CCC**  
1,261 lb.

**LENGTH**  
42' 10"

**HEIGHT**  
13' 5"

**WIDTH**  
101"



# 40CRS

**HITCH WEIGHT**  
1,345 lb.

**GVWR**  
13,345 lb.

**UVW**  
12,004 lb.

**CCC**  
1,341 lb.

**LENGTH**  
42' 5"

**HEIGHT**  
13' 5"

**WIDTH**  
101"

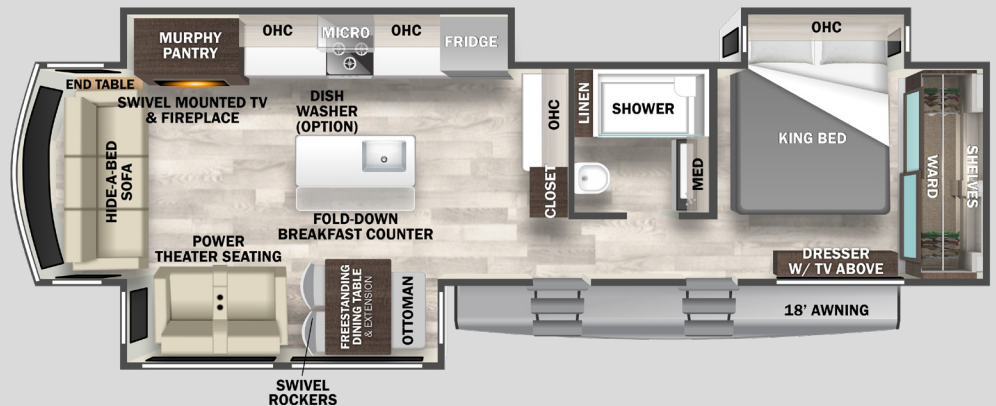

# 40CDL

**HITCH WEIGHT**  
1,696 lb.

**GVWR**  
13,696 lb.

**UVW**  
11,716 lb.

**CCC**  
1,921 lb.

**LENGTH**  
40' 6"

**HEIGHT**  
13' 5"

**WIDTH**  
101"



# 40RDE

**HITCH WEIGHT**  
1,695 lb.

**GVWR**  
14,000 lb.

**UVW**  
12,304 lb.

**CCC**  
1,696 lb.

**LENGTH**  
43'

**HEIGHT**  
13' 5"

**WIDTH**  
101"

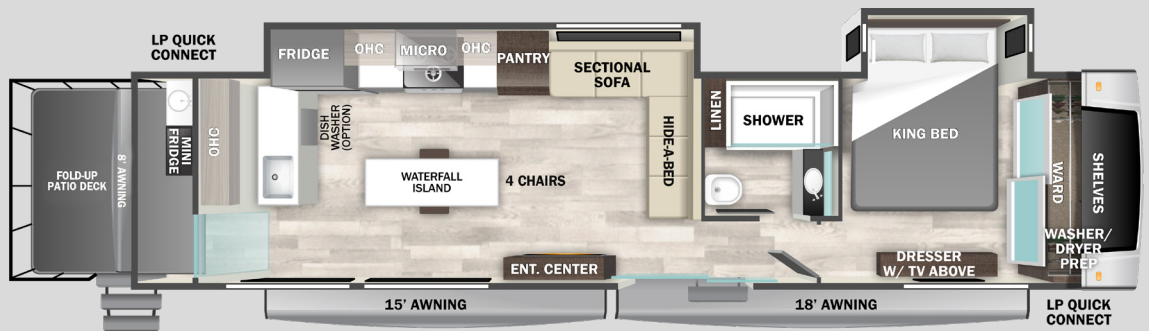

## INTRODUCING THE ALL NEW FIFTH WHEEL COTTAGE

# 41FWC

### FEATURES

- Printed Gelcoat Exterior
- 38" x 80" Friction Hinge, Black Glass
- Entry Door with New Entry Door Latch Extension
- Hydraulic Front Jacks
- 60" Smart TV with Backlighting in LR
- J-Lounge Sofa with Pull Out Trundle creating Full Size Sleeping area
- Double Pull-out Pantry
- Pull Out Double Trash Bins
- Pull Out Flatware Cylinders
- Matte Luxe Cabinets and Fascia
- Splendide Stack Washer / Dryer
- Integrated Blackout Blinds Throughout
- Suburban ST-60 60,000 BTU Tankless Water Heater

**HITCH WEIGHT**  
2,820 lb.

**GVWR**  
16,564 lb.

**UVW**  
14,314 lb.

**CCC**  
2,250 lb.

**LENGTH**  
42' 6"

**HEIGHT**  
13' 5"

**WIDTH**  
101"

### 41FWC OPTIONS ONLY

- 18' Exterior Power Awning
- 2nd Power Awning
- 3 sets of Stab Jacks (6 Total)

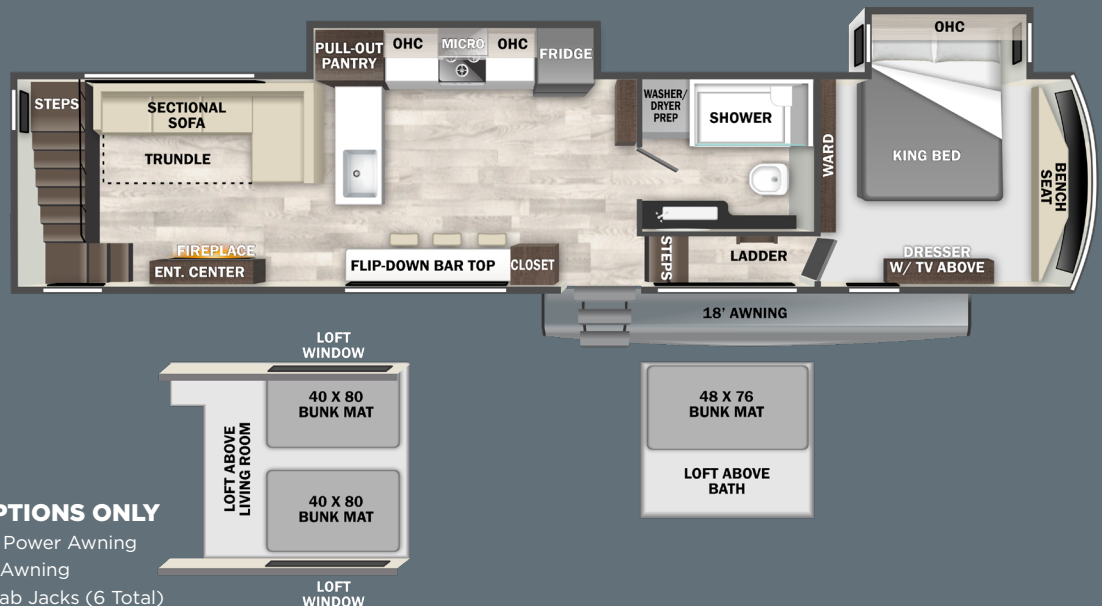

# CEDAR CREEK COTTAGE TOP FEATURE HIGHLIGHTS

## EXTERIOR

- 101" Wide Body Frame
- "True" Gelcoat Exterior (The Best of the Best in Exteriors)
- Cedar Creek's Famous All Aluminum Superstructure on 16" Centers or less
- 3M® Bonded Sidewalls—Resilient, they grow stronger with age. They also have outstanding resistance to UV, heat, cold, moisture, oils, gasoline, and highway chemicals, which creates a bond that cannot delaminate with time.
- (2) 6000# Axles / FW (3) #6000# Axles
- 4' x 6' ABS, Ribbed, Removable Underbelly Panels
- AlphaPly TPO Roof Membrane with Lifetime Warranty - 40% Thicker
- Wired for a 3rd AC
- 12 Volt Heating Pads on All Black, Grey, & Fresh Water Tanks
- Detachable Entry Steps
- Electric Awning with LED Night Lights (Option on 41FWC)
- Dual Pane Patio Door (TT Only)
- Individual Shut Off Valves - Kitchen and Bathroom
- New Waterproof, Bug Proof Vixenite Slide Room floor panels
- 2 Coleman MACH 8 Plus 15,000 BTU Air Conditioners
- 20 Gallon Electric Hot Water Heater with Bypass Kit
- One Year of™ RV Roadside Assistance
- Free Membership to Forest River Owners Group F.R.O.G.

## INTERIOR

### KITCHEN / LIVING ROOM

- 19.6 cu. Ft., Glass Front, 12v. Refrigerator with Icemaker
- 3 Burner Gas Oven with Pull Out Pan Drawer
- Flush Floor Slides in Kitchen and Living Area
- Residential Kitchen Island with Solid Surface Counter with Flush Mount, Stainless Steel, Work Station Sink
- Breakfast Flip-Up Countertop in Island (Travel Trailer Only)
- Cordless Sweeper

- Murphy Pantry (Travel Trailer Only)
- Residential Dovetail, Self-Closing Drawers, and Hidden Hinge Cabinet Doors
- Stainless Steel, 30" Over the Range Microwave
- Under Island Pullout Caddy & Baking Tray Storage (Travel Trailer Only)
- Cutting Board Drawer with Cut-out Trash funnel (Travel Trailer only)
- Power Fan with Rain Sensor Override in Kitchen
- Vinyl Floor Covering
- Dining table with (2) chairs, Storage Ottoman, Table Extension, and Hidden Silverware Drawer (Travel Trailer Only)
- Walnut / Two Tone Wooden Cabinets and Fascias (Travel Trailer Only)
- Day / Night Roller Shades (Travel Trailer Only)
- Power Theater Seating with USB charging ports
- Luxury Hide-a-Bed Sofa

## INTERIOR

### BATHROOM / BEDROOM

- 48" x 30" One Piece, Fiberglass Shower with glass doors, and Upgraded Shower Head
- Large Bath Vanity with Solid Surface Countertop (Where Applicable)
- Large Vessel Sink, Bath Vanity (Where Applicable)
- 18" High Porcelain Toilet with Top Circular Flush System
- Create-A-Breeze Circulation Fan
- Extra Storage for Linens
- LED Night Lighting under the Vanity
- Residential Style Headboard with Luxurious Bedding Décor
- Individual Reading Lighting above the Bed
- USB Ports
- Standard 72 x 80 King Bed
- Flip-Up Dresser Top with Hidden Storage
- Black-Out Night Shades (Travel Trailer BR Only)

- Extra wide Valances that can accommodate C-pap machines in Bedroom
- Prepped for an Optional Washer and Dryer
- 12v Motion lighting in the Closet

## ELECTRONICS

- 50" Smart Television w/Swing Arm (Travel Trailer Only)
- 32" Smart Television in the BR
- 12v. Bluetooth Stereo Speaker
- (2) Exterior Satellite & Cable Hook-Ups to Bedroom and LR
- New Cradle Point Wifi/5G Antenna and Day 1 Connectivity
- Pre-Wired for Satellite to the Roof

## AVAILABLE OPTIONS

- 12' Power Awning on Dining Slide
- Slide-Out Awning Toppers
- Cadet Wall Mounted Heater with Circulation Fan
- Fisher / Paykel Dishwasher Drawer in the Island (N/A 41FWC)
- Dual Pane Frameless, Tinted Windows (N/A 41FWC)
- Heat Pump on Main Air Conditioner
- 30" Convection Microwave (N/A 41FWC)
- Splendide Washer / Dryer (Standard in FW)
- Upgraded Luxury King Bed
- 4 Sets of Stabilizer Jacks (TT Only)
- 3 Sets of Stabilizer Jacks (FW Only)

## FABRIC CHOICES

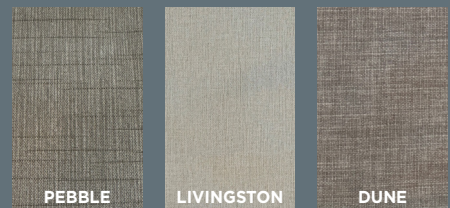

## LEATHERETTE

## FABRIC

# COTTAGE

CEDAR CREEK



## FOREST RIVER INC. CEDAR CREEK DIVISION

501 Hawpatch Road • Topeka, IN 46571  
Phone: 260-593-4013 • Parts & Service Phone: 260-593-4000

Visit our website at:

[forestriverinc.com/cedar-creek-cottage](http://forestriverinc.com/cedar-creek-cottage)

[@cedarcreekbyforestriver](https://www.instagram.com/cedarcreekbyforestriver)



Actual towing capacity is dependent on your particular loading and towing circumstances, which includes GVWR, GAWR and GCWR, as well as adequate trailer brakes. Please refer to the Owner's Manual of your vehicle for further information. All information contained in this brochure is believed to be accurate at the time of publication. However, during the model year, it may be necessary to make revisions and Forest River, Inc., reserves the right to make all such changes without notice, including prices, colors, materials, equipment and specifications as well as the addition of new models and the discontinuance of models shown in this brochure. Therefore, please consult with your Forest River dealer and confirm the existence of any materials, design or specifications that are material to your purchase decision. ©2024 Forest River, Inc., a Berkshire Hathaway company. All Rights Reserved. 8/24



[FORESTRIVERINC.COM](http://FORESTRIVERINC.COM)