

THE AHARA FULL PROFILE FIFTH WHEEL IS THE PERFECT BLEND OF LUXURY AND VALUE.

AHARA is a Sanskrit term used in yoga philosophy to refer to the vehicle, or support, of consciousness and is one of the basic principles upon which health, happiness and harmony rests. The **AHARA** name perfectly embodies the spirit of this thoughtfully designed luxury fifth wheel.

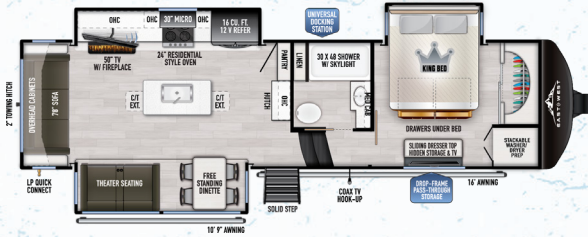

325RL

HITCH (LBS.): 2,185 U/VW (LBS.): 11,759 CCC (LBS.): 3,741 LENGTH: 34' 9"
 EXTERIOR HEIGHT: 13' 5" WIDTH: 102" TANKS (F/G/B): 64 / 88 / 44 AWNING: 10' 9" & 16'



365RL

HITCH (LBS.): 2,273 U/VW (LBS.): 12,345 CCC (LBS.): 3,928 LENGTH: 37' 4"
 EXTERIOR HEIGHT: 13' 5" WIDTH: 102" TANKS (F/G/B): 64 / 88 / 44 AWNING: 10' 9" & 18'



378BH-OK

HITCH (LBS.): 2,605 U/VW (LBS.): 14,109 CCC (LBS.): 2,496 LENGTH: 41' 5"
 EXTERIOR HEIGHT: 13' 6" WIDTH: 102" TANKS (F/G/B): 64 / 88 / 88 AWNING: 10' 9" & 16'



380FL

HITCH (LBS.): 3,190 U/VW (LBS.): 14,559 CCC (LBS.): 2,631 LENGTH: 41' 7"
 EXTERIOR HEIGHT: 13' 6" WIDTH: 102" TANKS (F/G/B): 64 / 88 / 88 AWNING: 14' & 16'

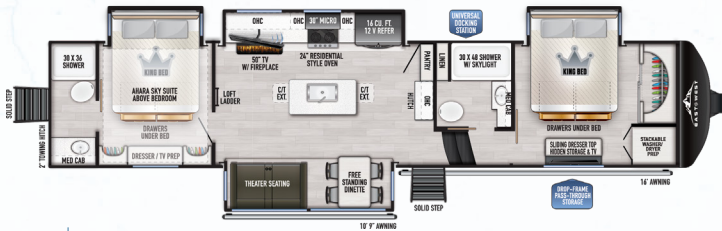

390DS

HITCH (LBS.): 2,800 U/VW (LBS.): 14,854 CCC (LBS.): 2,026 LENGTH: 42' 10"
 EXTERIOR HEIGHT: 13' 6" WIDTH: 102" TANKS (F/G/B): 64 / 132 / 88 AWNING: 10' 9" & 16'



EAST TO WEST

3000 CR 6 W | ELKHART, IN 46514
 574.264.6664 | WWW.EASTTOWESTRV.COM

** PIN TO BUMPER / * AVERAGE WEIGHTS + F = FRESH, B = BLACK, G = GRAY

#GOEASTTOWEST



WE ARE SENDING OUT 12.11.24 VERSIONS, ANYTHING EARLIER PLEASE DISCARD.



395FB

HITCH (LBS.): 2,820 U/VW (LBS.): 16,164 CCC (LBS.): 2,656 LENGTH: 44' 4"
 EXTERIOR HEIGHT: 13' 6" WIDTH: 102" TANKS (F/G/B): 64 / 132 / 88 AWNING: 16' & 18'



TRAVEL TRAILERS



TOY HAULERS



FIFTH WHEELS



MOTORHOMES

EAST TO WEST TAKES PRIDE IN OUR FIVE GUIDING PRINCIPLES AND OUR CORPORATE PHILOSOPHY which focuses on people working together to create high quality, value-added products that deliver the ultimate RV experience.

Sustainable Manufacturing

An important objective to our strategy and operations is to implement economically sound manufacturing processes to reduce/ recycle waste & conserve energy and natural resources.

Corporate & Social Responsibility

We foster a business environment in which we focus on and practice:
 - Ethical Labor Practices
 - Teamwork
 - Philanthropy
 - Volunteering

Culture & Values

We are a forward thinking company committed to fostering a culture of teamwork. By being transparent, we encourage our employees to think outside the box and make a difference!

Quality & Construction

Our team takes pride in each unit we build. Our manufacturing standards and point to point inspections ensure each EAST TO WEST brand is built to the same quality specifications every time.

Our Commitment

We strive to provide the highest quality products at the best possible price to our customers. We invite you to be a part of the EAST TO WEST family and we look forward to exceeding your expectations!

EACH NEW FOREST RIVER PURCHASE PROVIDES:

- ✔ Pre-delivery Inspection. ✔ Digital Owner's Manual.
- ✔ Free Membership to Forest River Owners Group (FROG).
Learn more at www.forestriverfrog.com.
- ✔ A Contribution to Care Camps Foundation www.carecamps.org.
- ✔ 1 Year Free Roadside Assistance from Date of Purchase.



LEARN MORE:

Scan this QR code with your mobile device to learn more about Forest River.



SPECIFICATION DEFINITIONS:

Scan this barcode using a QR reader on your smartphone to learn RV terminology and more!

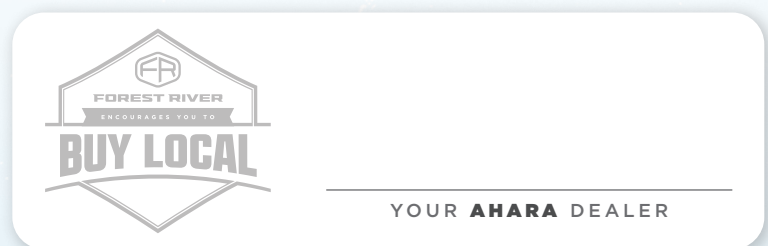

All information contained in this brochure is believed to be accurate at the time of publication. However, during any model year, it may be necessary to make changes to the manufacturing process of the units and information in this brochure. Your unit may differ from the information in this brochure due to any changes in the manufacturing process and equipment. Forest River, Inc. reserves the right to make all such changes without notice, including prices, colors, combinations, materials, equipment and specifications of any model as well as the addition of new models and the discontinuance of models shown in this brochure. Therefore, please consult with your Forest River dealer and confirm the availability of any materials, combinations, designs, or specifications that are meaningful to your purchase decision. © 2025 Alta, a Division of East to West, Inc., a Berkshire Hathaway Company. All Rights Reserved. Forest River, Inc. 01/25